

WORK IN TRAVEL LANE OR SHOULDER - TWO LANE HIGHWAY (MOVING OPERATION)

PARKING AREA FOR VEHICLES DURING LITTER
REMOVAL WILL BE DETERMINED FOR EACH
PERMITTED AREA BY THE TOWN OF SOUTH
WINDSOR'S DEPARTMENT OF PUBLIC WORKS.

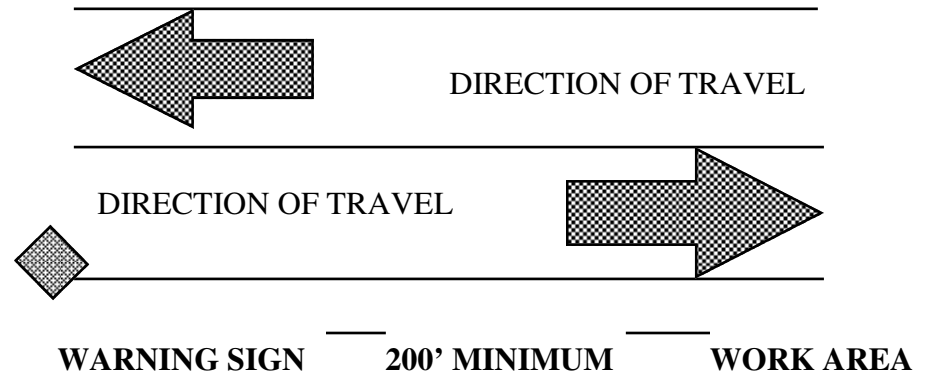

**TOWN OF SOUTH WINDSOR PUBLIC WORKS DEPARTMENT
TRAFFIC CONTROL PLAN**