

© 2021 SLR International Corporation. All rights reserved. This drawing is the property of SLR International Corporation and is not to be reproduced or used in any form without the written consent of SLR International Corporation.

ZONING DATA TABLE

	REQUIREMENT	REQ'D/PERMITTED	PROVIDED
MINIMUM	TOTAL LOT AREA (S.F., AC.)	174240 (4 AC.)	275,515 (6.324 AC.)*
	FRONT YARD (FT.)	50	50
	SIDE YARD (FT.)	25	25 / 50
	REAR YARD (FT.)	25	25
MAXIMUM	BUILDING HEIGHT (FT.)	35	29'-1"
	BUILDING COVERAGE (%)	15	14
	IMPERVIOUS COVERAGE (%)	50	40

\*INCLUDES 1.13 AC TO BE PLACED INTO CONSERVATION

REQUIRED PARKING TABLE

REQUIREMENT	REQ'D/PERMITTED	PROPOSED
TOTAL SPACES	108 SPACES	136 SPACES
HANDICAP SPACES	5 SPACES	6 SPACES

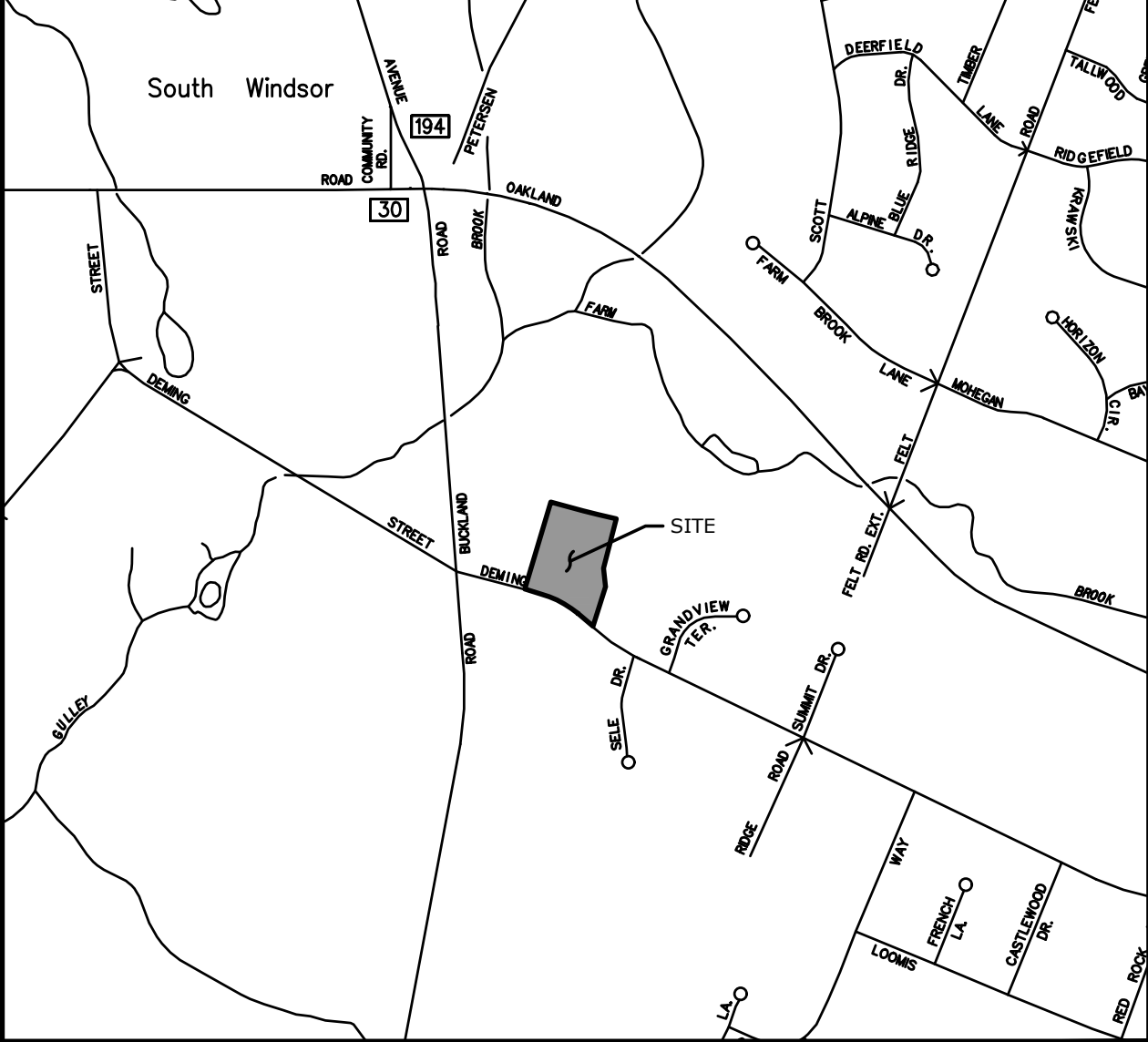
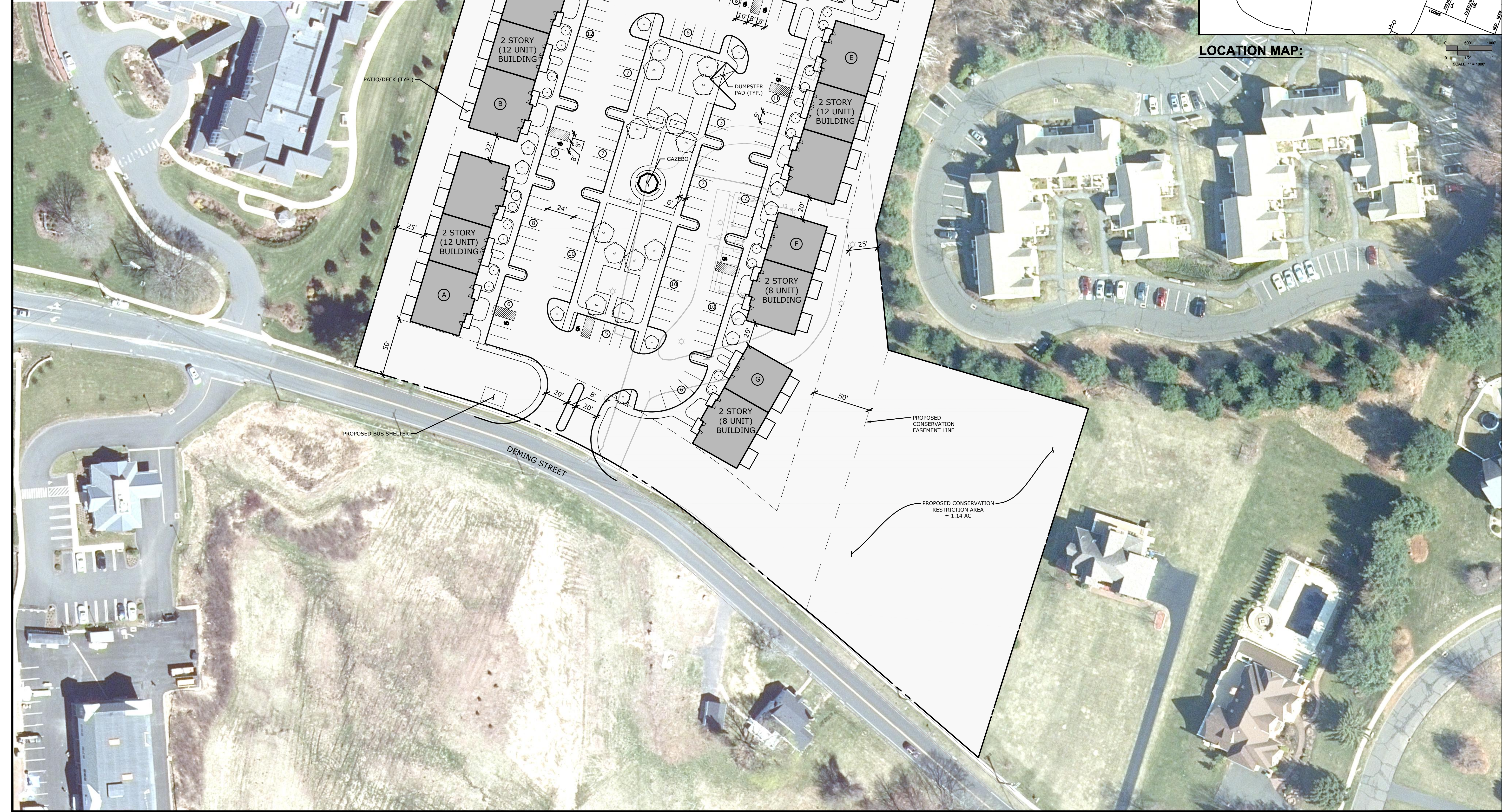

LOCATION MAP:

SLR

99 REAR DRIVE  
203.271.1773  
SLRCONSULTING.COM

PRELIMINARY SITE PLAN

MULTI-FAMILY DEVELOPMENT

240 DEMING STREET  
SOUTH WINDSOR, CONNECTICUT

RYE

LCD

RYE

DESIGNED

DRAWN

CHECKED

SCALE

1"=40'

DATE

MAY 12, 2023

PROJECT NO.

13571.00069

SHEET NO.

LA

DESCRIPTION

DATE

BY

Copyright SLR International Corporation - 2021